

4

3

2

1

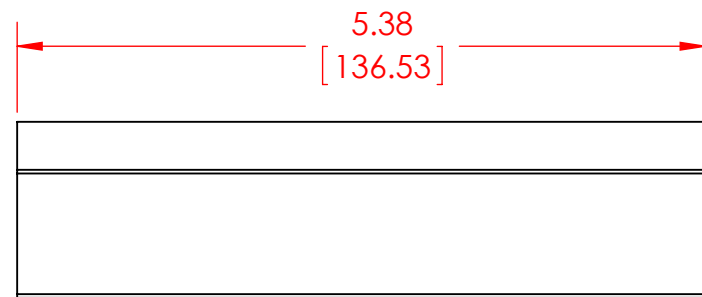
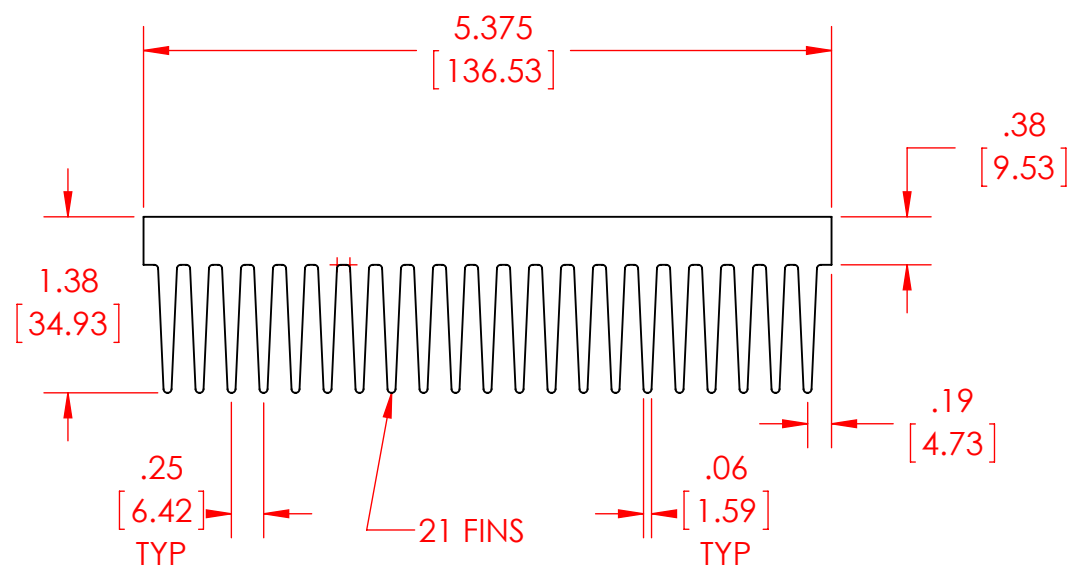
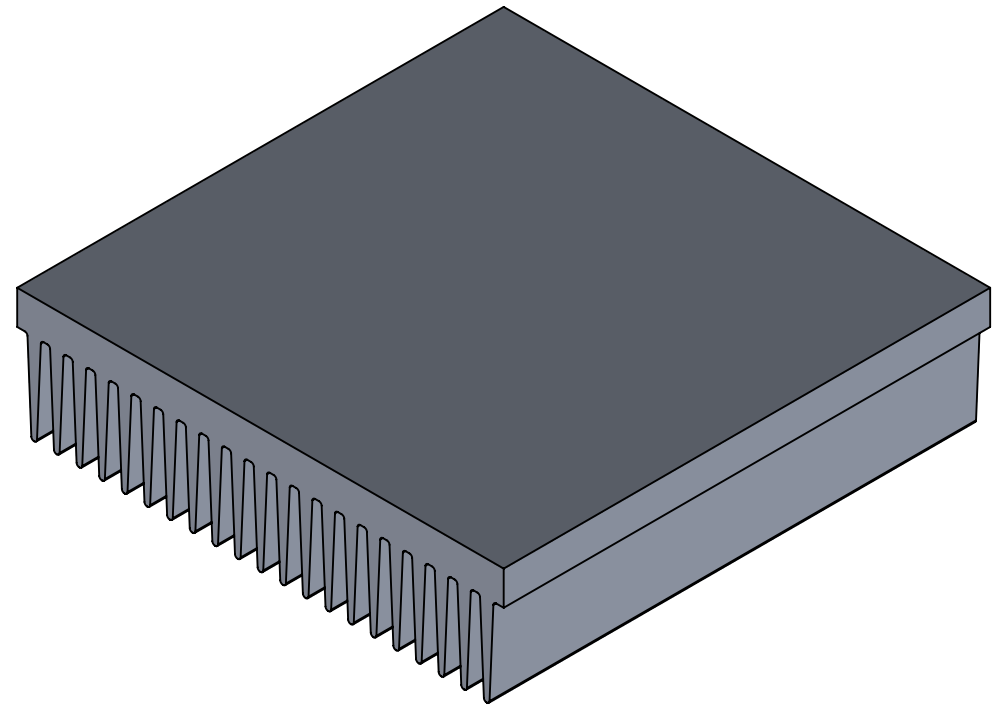
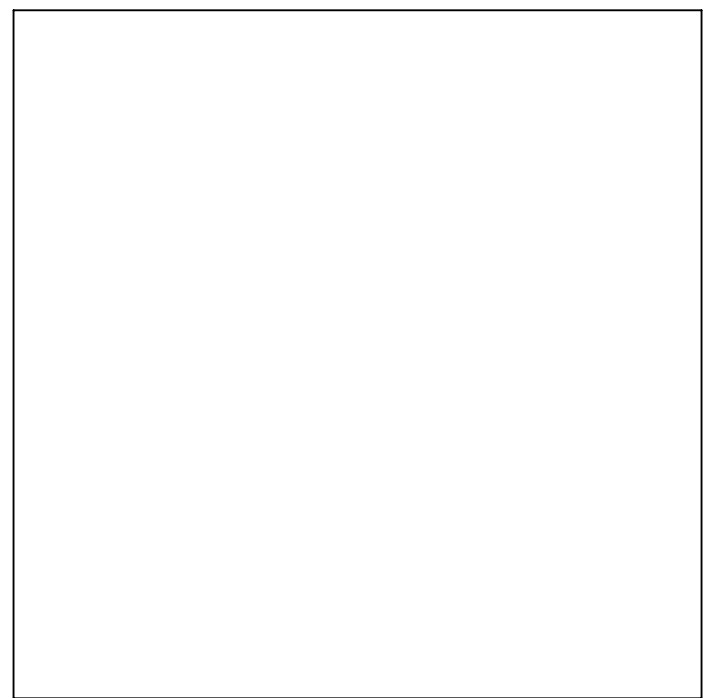

- NOTES:**
1. DIMENSIONS ARE IN INCHES AND [MM].
  2. MATERIAL: ALUMINUM 6063 T5.
  3. REMOVE ALL BURRS AND SHARP EDGES.

PROPRIETARY AND CONFIDENTIAL THE INFORMATION CONTAINED IN THIS DRAWING IS THE SOLE PROPERTY OF CUSTOM THERMOELECTRIC, LLC. ANY REPRODUCTION IN PART OR AS A WHOLE WITHOUT THE WRITTEN PERMISSION OF CUSTOM THERMOELECTRIC, LLC IS PROHIBITED.	UNLESS OTHERWISE SPECIFIED:	NAME	DATE	11941 Industrial Park Road, STE 5 Bishopville, MD 21813	
	DIMENSIONS ARE IN INCHES	DRAWN	AEM		10/09/2014
	TOLERANCES:	CHECKED			
	FRACTIONAL ±.03	ENG APPR.			
	ANGULAR: MACH ±0°30' BEND ±1°	MFG APPR.			
TWO PLACE DECIMAL ±.01	Q.A.			<b>TITLE:</b> <b>HEAT SINK</b> <b>EXTRUDED, 21 FIN</b> <b>5.38 x 5.38 x 1.38"</b>	
THREE PLACE DECIMAL ±.005	COMMENTS:				
SURFACES TO BE PERPENDICULAR WITHIN .005 T.I.R.				SIZE <b>B</b> DWG. NO. HS-5.4-5.4-1.4-01_PUBLIC REV <b>A</b>	
SURFACES TO BE PARALLEL WITHIN .005 T.I.R.				SCALE: 1:1 WEIGHT: SHEET 1 OF 1	
HOLE ANGULAR TOLERANCE ±0°5'					
INTERPRET GEOMETRIC TOLERANCING PER: ANSI Y14.5					
MATERIAL					
FINISH					
	DO NOT SCALE DRAWING				

REV.	DATE	DESCRIPTION	REV.	DATE	DESCRIPTION
A	10/09/2014	INITIAL RELEASE			

4

3

2

1

B

B

A

A