

TEC Specification Sheet

Thermolyte Part #	I _{max} (Amps)	Q _{max} (Watts)	V _{max} (Volts)	DT _{max} (°C)	T _{max} (°C)
12701-9L31-12BW1	12.0	100.1	16.5	67°C	200°C

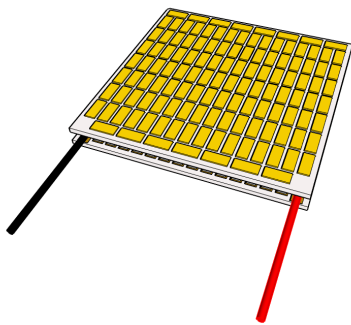

Metallized

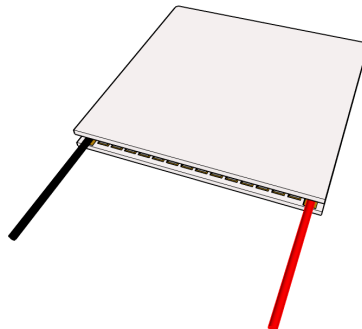

Lapped

Custom Options:

Call for custom wire types and other custom options.

Notes:

Typical power input is 40% to 80% of I_{max}

Maximum Waste Heat (exiting the hot side) at 100% input power, I=I_{max}, V=V_{max} is;

$$(I_{\max} * V_{\max}) + Q_{\max} = 298.1 \text{ watts}$$

Use of a properly sized heat sink or water block is required to remove waste heat.

Bottom Plate				Top Plate				Metallized Height		Lapped Height	
A		B		C		D		H		H	
mm	in	mm	in	mm	in	mm	in	mm	in	mm	in
50.80	2.00	50.80	2.00	50.80	2.00	50.80	2.00	4.57	.180	4.06	.160

Weight (w/o leads)
- grams

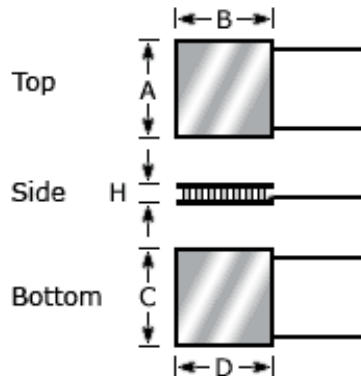

OR

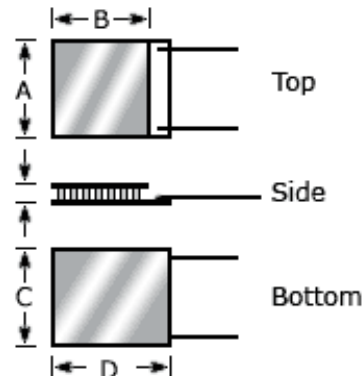

Tolerances (typical)
A, B, C, D = ±0.25mm (±0.01")
H = ±0.15mm (±0.006")

